



WELCOME TO MURAD APPARELS LTD.



Factory Profile

OF

Murad Apparels Ltd.

South Gouripur, Ashulia,

Savar, Dhaka-1341, Bangladesh.

CERTIFICATIONS



APPROVED BY



Index

➤ **Contents**

- Introduction about Murad Apparels Ltd.
- Facilities
- Address
- Factory Details
- Production Capacity
- Product
- Fabrics
- Customer
- Sewing Floor Lay out
- Finishing Floor Lay out

Index

- Ground Floor Lay out
- Store Department
- List of Machineries
- Special Machines
- Sample Section
- Cutting Section
- Sewing Section
- Quality Assurance
- Sewing Quality Control
- Finishing Department
- Process Follow For Finishing of Trouser
- Management

Introduction

Murad Apparels is a fully export-oriented, integrated manufacturer of ready-made woven garments. Established in 1995, the factory operates with 16 production lines on a 57-acre site. Our annual turnover ranges between \$10 million and \$20 million.

We provide end-to-end solutions in sourcing, procurement, production, quality assurance, follow-up, creative development, image production, and logistics. Our service model enhances brand management and boosts efficiency while minimizing costs and ensuring security.

Our work is defined by an unwavering dedication to style, quality, punctual delivery, clear communication, professionalism, and operational efficiency. Quality is the cornerstone of our business—it informs every decision, from selecting materials to delivering top-tier customer service.

We specialize in outerwear and a wide range of bottoms, including items made from suede and PU leather. Our facilities are certified by GOTS, BSCI, SeDex, WRAP, Oeko-Tex, OCS, ACCORD, ISO 9001:2015 (QMS), and C-TPAT, and we hold self-certifications from INDITEX and KIK. Lead times typically range from 90 to 120 days.

Our commitment to exceptional quality is the key to both our success and your satisfaction.

Facilities

- ✓ We have a highly capable merchandising team that independently manages product development, sampling, sourcing, and the entire supply chain.
- ✓ We source fabrics from China, India, Pakistan, as well as from local suppliers.
- ✓ Our material expertise includes denim, twill, canvas, corduroy, linen, polyester, and poplin.
- ✓ Woven Division: We excel in producing a wide variety of garments, including jackets, bibs, cargo pants, fancy 5-pocket styles, chinos (both standard and active), and both washed and unwashed items.
- ✓ Knit Division: We specialize in all types of activewear, including hoodies, joggers, and shorts.
- ✓ Equipped with the latest, state-of-the-art machinery and tools.
- ✓ Spacious and compliant work environment for every employee, aligned with international labor standards

Facilities

- ✓ Up-to-date firefighting systems and clearly defined emergency evacuation plans, in accordance with labor law regulations.
- ✓ Comprehensive group insurance coverage for all staff and workers, as mandated by the Labor Law of 2006.
- ✓ On-site medical facility staffed with qualified doctors and nurses, fully equipped for emergencies, and stocked with essential medicines—ensuring compliance with the Labor Law of 2006.
- ✓ Separate sick rooms are available for male and female workers.
- ✓ A clean and hygienic environment is maintained throughout the facility.
- ✓ A day-care center is provided for the children of female workers, in accordance with labor law policies. It includes a play area and a dedicated room for breastfeeding.
- ✓ Dining hall facilities are available for all factory workers and staff, as required by labor law.
- ✓ Wall-mounted exhaust fans are installed to ensure proper ventilation and a cooler working environment.

Facilities

- ✓ 24 hours standby generator facility. Capacity 620 KWE, made in Germany
- ✓ 33000 KVA electric supply system for 24/7 electric facility.
- ✓ All over the factory well designed layout and fire evacuation plan for easy exit during emergency time.
- ✓ Separate Prayer rooms for male & female workers.
- ✓ Murad Apparels Ltd is fully equipped with public announcing system (PA system)
- ✓ For emergency exit each floor is having 4 numbers of staircases.

Factory Address & Bank Details

Factory

Murad Apparels Limited

South Gouripur, Asulia,

Savar, Dhaka-1341, Bangladesh .

Bank Details

EXIM Bank Limited.

Motijheel Branch

Dhaka, Bangladesh .

Web : www.eximbankbd.com

SWIFT : EXIBKBDDH001

Contact Person



MD. ABDUL HANNAN
Chairman

+880 1713012701 
chairman@muradapparels.com 
South Goripur, Ashulia, 
Savar, Dhaka-1341
www.muradapparels.com 



Nafisa Saima
Director

+44 7547 741305 
nafisa@muradapparels.com 
South Goripur, Ashulia, 
Savar, Dhaka-1341
www.muradapparels.com 



Abdullah Hannan
Director

+447933291037 
abdullahhannan@woventex.co 
South Goripur, Ashulia, 
Savar, Dhaka-1341
www.muradapparels.com 



Shajadul Hasan (Shazal)
Manager (Marketing & Merchandising)

+88 01833101294 
+88 01873358809 
shajadul@muradapparels.com 
South Goripur, Ashulia, 
Savar, Dhaka-1341
www.muradapparels.com 

Factory Details

- **Work Force:** At this moment there are 1900 workers and staff working together.
- **Factory Space:** 3 stored building. Ground floor is cutting and finishing, 1st and 2nd floor for sewing and also have a six storied building beside of main building which is bonded warehouse & finished goods store.
- **Building Total Space :** Total 1,26,990 Sft. Each Floor 42,330 SFT.
- At this moment our production capacity is **500,000** pcs per month.
- Outwear can do 120K and Bottom 260K per month and **kint 200,000 to 300,000** PCs.
Consideration of 26 working days in a month.
- Woven Total 16 lines & each lines of 65-70 machines.

Our Products

We can manufacture all kind of washed and non washed woven Garments such as..

Woven:

- All kinds of Jacket
- Bib
- Coverall
- Cargo Pants
- Swim Shorts
- Fancy 5 pockets Jeans
- 5 pockets Pants
- Chino Pants
- Sports wear
- PU Leather Jacket and Bottom
- Night Wear Set

Knit:

- Hoodies
- Skirt
- Jogger
- Leggings
- Short Pant
- Night Wear Set

FABRICS WE CAN HANDLE

➤ Denim: All kinds of denim fabric

➤ Chambray

➤ Twill: All kinds of twill fabric

➤ Oxford Fabric

➤ 100% Polyester

➤ 100% Nylon

➤ CVC

➤ TC

➤ Fleece

➤ Poplin

➤ Bonded Fabric

➤ PU/Faux Leather & SUEDE Leather

➤ Coated Fabric

➤ Soft-shell

➤ Viscose

➤ Corduroy

➤ Linen

➤ American Crape

➤ Poly Moss etc.

Our Main Customers

- | | |
|------------------------|-----------|
| ➤ PROIN-PINILA | - SPAIN |
| ➤ ROSSINI | - ITALY |
| ➤ JUST EAT | - UK |
| ➤ Le Vent Doux Gallery | - Japan |
| ➤ LIDL | - Germany |
| ➤ Stooker Brands | - Germany |
| ➤ Norma | - Germany |
| ➤ Selling Group | - Denmark |
| ➤ Startex | - Denmark |
| ➤ USPA | - Denmark |
| ➤ ROSS | - USA |
| ➤ INDITEX | - SPAIN |
| ➤ Blue Notes | - Canada |
| ➤ Giant Tiger | - Canada |

Our Customers

ZARA

ZARA
HOME

stradivarius

UTERQÜE

INDITEX



OYSHO

Massimo Dutti

PULL&BEAR

Bershka



SORBINO

ellesse

INDICODE

new age technology



Our Customers



terranova



BLU NOTES

Sewing Floor Layout

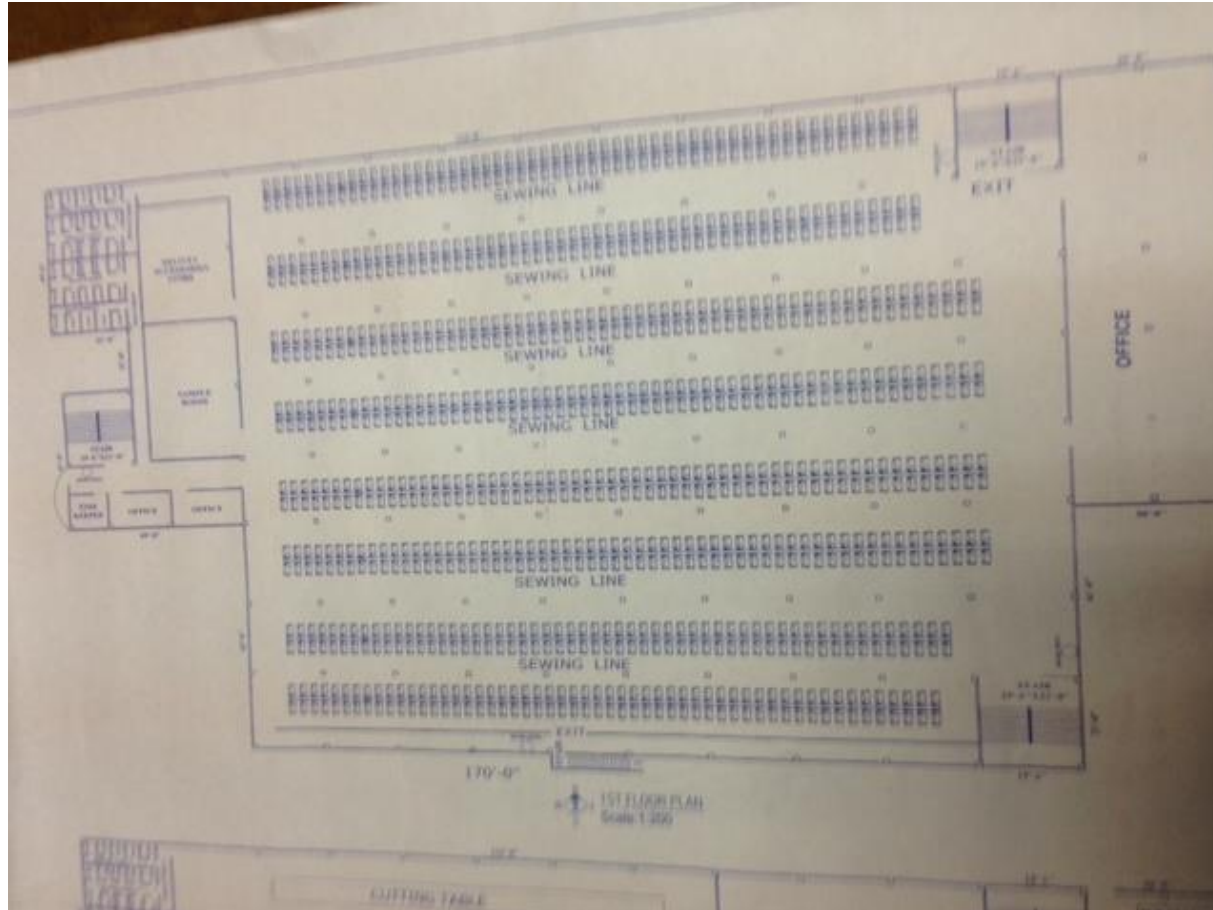

Cutting Floor Layout

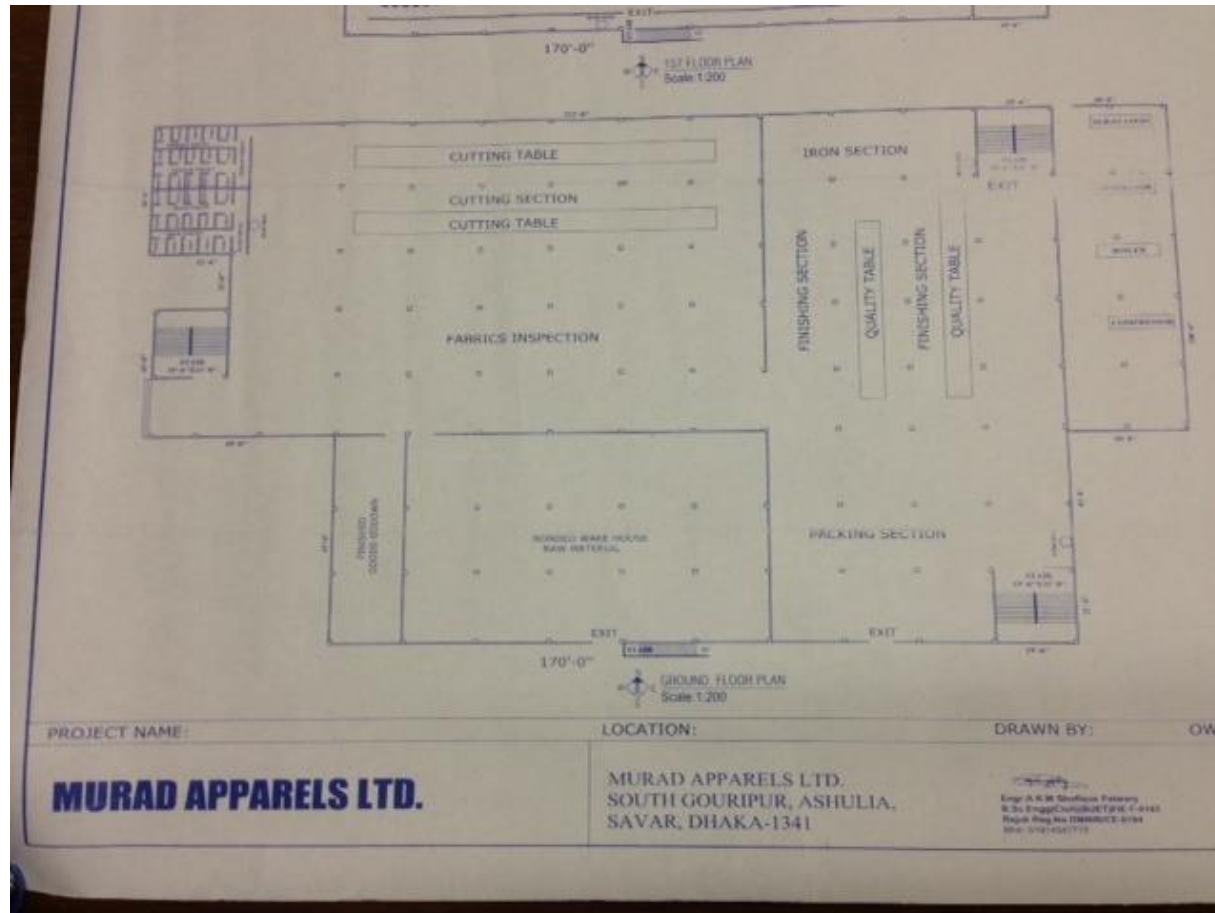

Storing Facility:

- For any new order, all the raw materials (Shell fabric, pocketing fabric, fusing, trims and accessories, etc.) are received by the store department.
- Main functions of store department
- Fabric inspection 4 point system
- Accessories inspection AQL 2.5
- To maintain an inventory of all the material received.
- To issue material to the various departments as per their requirement.
- The material which are maintained by the stores department Fabric ,Trims, Machinery and equipments.



List of Machineries

Machine Name	Nos.
Plain Machine	396
Plain Machine Auto	368
Vertical Plain Machine	4
Kansai Machine	11
Kansai Special	8
Two Needle Machine	44
Two Needle Auto Machine	11
Over Lock Machine	176
Over Lock Auto Machine	50
Feed of the Arm	20
Button Hole Manual	8
Button Hole Auto	0
Button Stitch	12

Bartack Machine	33
Blind Stitch Machine	9
Arm Hole Machine	3
Snap Button Machine	41
Snap Button Auto Machine	1
Eyelet Hole Machine	6
Zig Zag	25
Saddle Stitch Machine	2
Leather Base Stitch Machine	2
Bon Pocket Join Machine	1
Cutting Machine	10
Fusing Machine	2
Blower Machine	1

Steam Boiler	1
Flad lock	14
Flad Lock auto	1
Flad lock Flat bed	1
Cylinder Flad Lock	2
Chain Stitch	31
Steam Iron	32
Vacuum Table for Iron	24
Thread Sucking Machine	3
Fabric Inspection Machine	1
Fabric Inspection Table	1
Snap Pull Test Machine	2
Light Box	1

Sample Section

Sampling is the process by which a small number of garments are made so as to match the buyer requirement and to get approval from the buyer



Main functions of sampling department.

To develop samples as per the buyers requirements.

To develop a fabric consumption report for each order.

Various samples which are being developed at different stages are being mentioned below:-

- a) Proto Sample
- b) Fit Sample
- c) Sales Sample
- d) Pre Production Sample
- e) Size Set Sample



Cutting Section

Cutting is one of the important department of the manufacturing unit. The first stage in the manufacture of the garments is the cutting of the materials into the necessary patterns shapes.



The pattern shapes for these garments maybe drawn on a paper marker placed on top of the lay, or information as to their shape and position maybe held within a computer, to be plotted similarly on the paper marker or used to drive an automatic cutter.

Sewing Department

Sewing department is responsible for stitching the garment as per the sample and Tec pack provided by the sampling department.

Assembly line system is followed here with a combination of modular system. In this system there are different line/teams which individually do the production. The team works on few garments at a time instead of a bundle of garments and the operators are continuously motivated to work as a team and try to achieve the target production.



Quality Assurance

Piece Goods Quality Control

After 100% inventory, all the trims item with all accessories has to inspected as per AQL standard 1.5 . Failed items has to be keep on hold and it has to inform to merchandiser immediately and reject specimen has to be sent to merchandiser along with inspection report. Based on merchandising approval it has to be done 100% inspection before issuing trims & other accessories to production. Quantity less than 10,000 should be checked 100% .

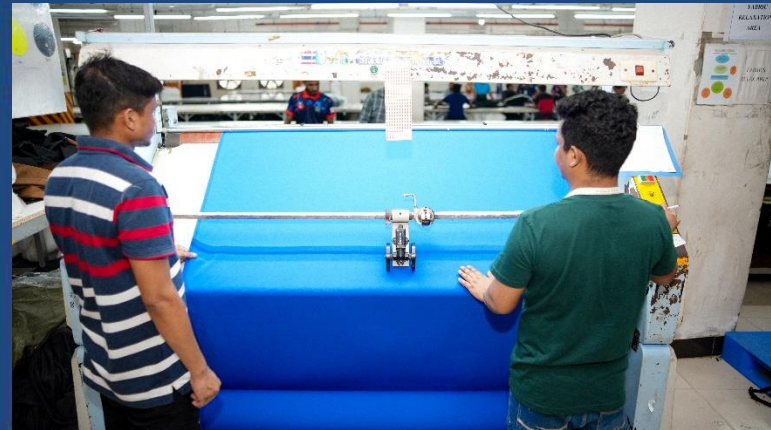

Sewing Quality Control Policy

- ✓ If defect is found keep line supervisor informed and operator to carry Yellow tag
- ✓ If the defect was not corrected (repeated) in the next hour. Random check of cut panels at input section.
- ✓ 100% inspection at assigned initial key operation by line Q/C.
- ✓ operator will be marked with Red tag until the defect is corrected. Consult QC whether to stop the operation.
- ✓ QC is required to check all operators within first hour of work to ensure standards.
- ✓ Random inspection at key operations to be carry out by QC for 10 garments (or pieces) and allow only one defect with own judgment or reject the whole bundle and hand over to line supervisor. All defective garments to be marked.
- ✓ Recheck the operation within next hour or at intervals of 10 min, 20 min, etc depending on the gravity of fault .

Finishing Department



Process flow for finishing of a Trouser

S.no	Operation	M/C used
1	Button Stitch	B/S m/c
2	Extra Loop Cut	
3	Thread Trimming Inside)	Trimmer
4	Iron Inside)	Iron
5	Quality Check (Inside)	
6	Thread Sucking	Sucker mc
7	Trim Threads outside)	Trimmer
8	Dust Removing	Air Jet
9	Inspection	
11	Buck Press W.B. , Front , Back	Buck Press

S.no	Operation	M/C used
12	Topper Finish	Topper
13	Final Iron	Iron
14	Measurement Check	
15	Final Inspection	
16	Staple W.B./joker Tag	Plastic Stapling
17	UPC Attach	Tag Gun
18	Size Sticker Attach	
19	Brushing	
20	Folding	
21	Poly Bag Packing	
22	Carton packing	



Doctor's Room

Medical room with specialized doctor & nurses with emergency supporting equipment with medicines as per labor law policy. Two separate sick rooms for Men & woman with four numbers of beds in each category for rest.



Day-care Centre

Day-care center for babies of female workers as per labour law policy, including playing place with separate room for Breast feeding.



Skill Building & Awareness Meeting

Has taken special measure by providing full equipped training centre / conference hall for workers .



Needle Control

There are well maintain needle Policy

All needles, or parts of broken/damaged needles must be accounted for throughout the production process and complete manufacturing unit.

Without exception, when a needle breaks the operator must find *all the fragments*.



Dining & Pure Drinking Water



Dining hall facility for all factory workers & staff as per labour law policy.

Clean and hygienic environment everywhere.

Filtered drinking water is available for workers in production floor as well as dining hall.

Laws & Securities

- Modern firefighting equipment and easy evacuation plan for emergency exit as per labour law policy.



Products- Ladies Outwear



Products- Ladies Outwear



Products- Men's Outwear



Products- Ladies Bottom



Products- Ladies Bottom



Products- Men's Bottom



Products- Men's Bottom



KNITWEAR



KNIT ITEMS



Conclusion

Our conclusion is mainly to give end customer good quality finished products & keep delivery on time. Therefore, we have professional expert to manage our entire factory smoothly. We have recruited the most experience staff and Skilled workers to ensure our commitment of high-quality cloths to our customers.

Moto of Murad Apparels Ltd. :

Our business policy is “Fashion and Quality garments at the best price within a committed time frame” We don’t compromise with any of them. The good prices are ensured due to good sources, efficient production planning and a good Quality Assurance system. We commit to supply top quality product at the best possible price.

Lead Time: Average Lead time of 90 to 120 days.

Thanking You

